



TRANSFORMER COMPONENTS??
ASK ASCO!!

www.ascocomponents.co.uk

info@ascocomponents.co.uk

EI66 UK Patt 147

**Lam
55x66**

TYPE	REF.	a	b	c	d	e	f	g	h	x1	x2	x3	s	L	GL	G	Number of Terminals
EI 66/22	2222A/1-2	22,8	22,5	32,5	41,8	50,2	29,8	13,5	14,5		35,0	5,0			■		4x8
EI 66/25	2225A/1-2	22,8	25,5	32,5	41,8	53,2	29,8	13,5	14,5		35,0	5,0			■		4x8
EI 66/30	2230A/1-2	22,8	30,5	32,5	41,8	58,2	29,8	13,5	14,5		35,0	5,0			■		4x8
EI 66/35	2235A/1-2	22,8	35,5	32,5	41,8	63,2	29,8	13,5	14,5		35,0	5,0			■		4x8
EI 66/40	2240A/1-2	22,8	40,5	32,5	41,8	68,2	29,8	13,5	14,5		35,0	5,0			■		4x8
EI 66/45	2245A/1-2	22,8	45,5	32,5	41,8	73,5	29,8	13,75	14,75		35,0	5,0			■		3x8
EI 66/55	2255A/2	22,8	55,5	32,5	41,8	83,5	29,8	13,75	14,75		35,0	5,0			■		

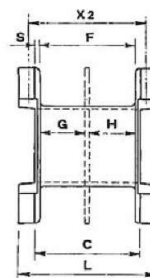
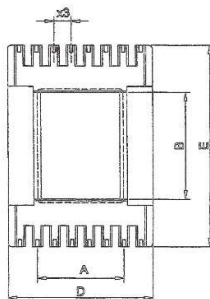
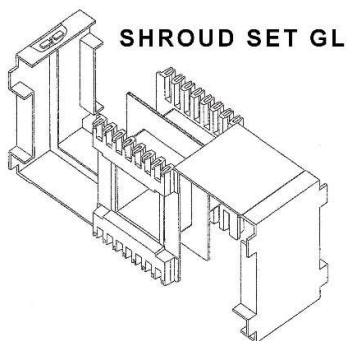

TEMPERATURE AND FLAMABILITY RATINGS OF STANDARD MATERIALS

Material Ref	Base Material	Temperature Class (2000h)	Conforming to standards	UL94
RP3	Nylon6 +30% glass reinforced	F (155°C)	IEC85 ASTM ISO/VDE DIN	HB
RP5	Nylon 6.6 +25% glass reinforced	B (130°C)		V0
RP7	Pet +30% glass reinforced	H (180°C)		V0